

# ANNEXATION PLAT

FOR A TRACT OF LAND IN THE SOUTHWEST QUARTER OF  
SECTION 22, TOWNSHIP 3 NORTH, RANGE 9 WEST OF THE 3rd  
PRINCIPAL MERIDIAN, MADISON COUNTY, ILLINOIS

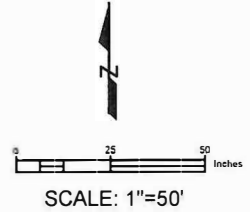

115

FIRST ADDITION  
TO MEADOW HEIGHTS  
PB 22 PG 66

116

117

104

SECOND ADDITION  
TO MEADOW HEIGHTS  
PB 22 PG 80

103

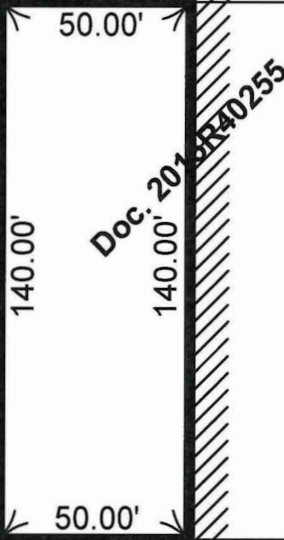

LOST AVE.

Doc. 2009R59034

KNEEDLER ST.

Doc. 2017R21770

Doc. 2012R19215

1

LOST HILLS  
SUBDIVISION  
PB 56 PG 126

WE, THE CITY OF COLLINSVILLE HAVE  
PREPARED THIS PLAT FOR  
ANNEXATION PURPOSES.

KEVIN MADDEN PE 062.071784  
APRIL 4, 2025

LIC. EXPIRATION DATE: NOVEMBER 30, 2025

## LEGEND



EXISTING CORPORATE LIMITS LINE



SHEET TITLE:  
EXHIBIT B - ANNEXATION PLAT

